

AREA PLAN

HAYGARTH HOUSE

28-31 High Street, WIMBLEDON, SW19



Second Floor

IPMS3 Office Area Plan

	IPMS 3	465.0 sq m	5005 sq ft
---	--------	------------	------------

LIMITED USE AREAS

The following areas are 'Limited Use' Areas within the TOTAL Area:

	Internal Dominant Face (IDF)	2.2 sq m	24 sq ft
	Structure	3.3 sq m	36 sq ft
	Restricted Headroom	4.7 sq m	51 sq ft

Net Internal Area

	NIA	454.8 sq m	4895 sq ft
---	-----	------------	------------

The following has been EXCLUDED from the TOTAL NIA:

Restricted Headroom	XX.X sq m	XX sq ft
---------------------	-----------	----------

Gross Internal Area

	GIA	533.1 sq m	5738 sq ft
--	-----	------------	------------

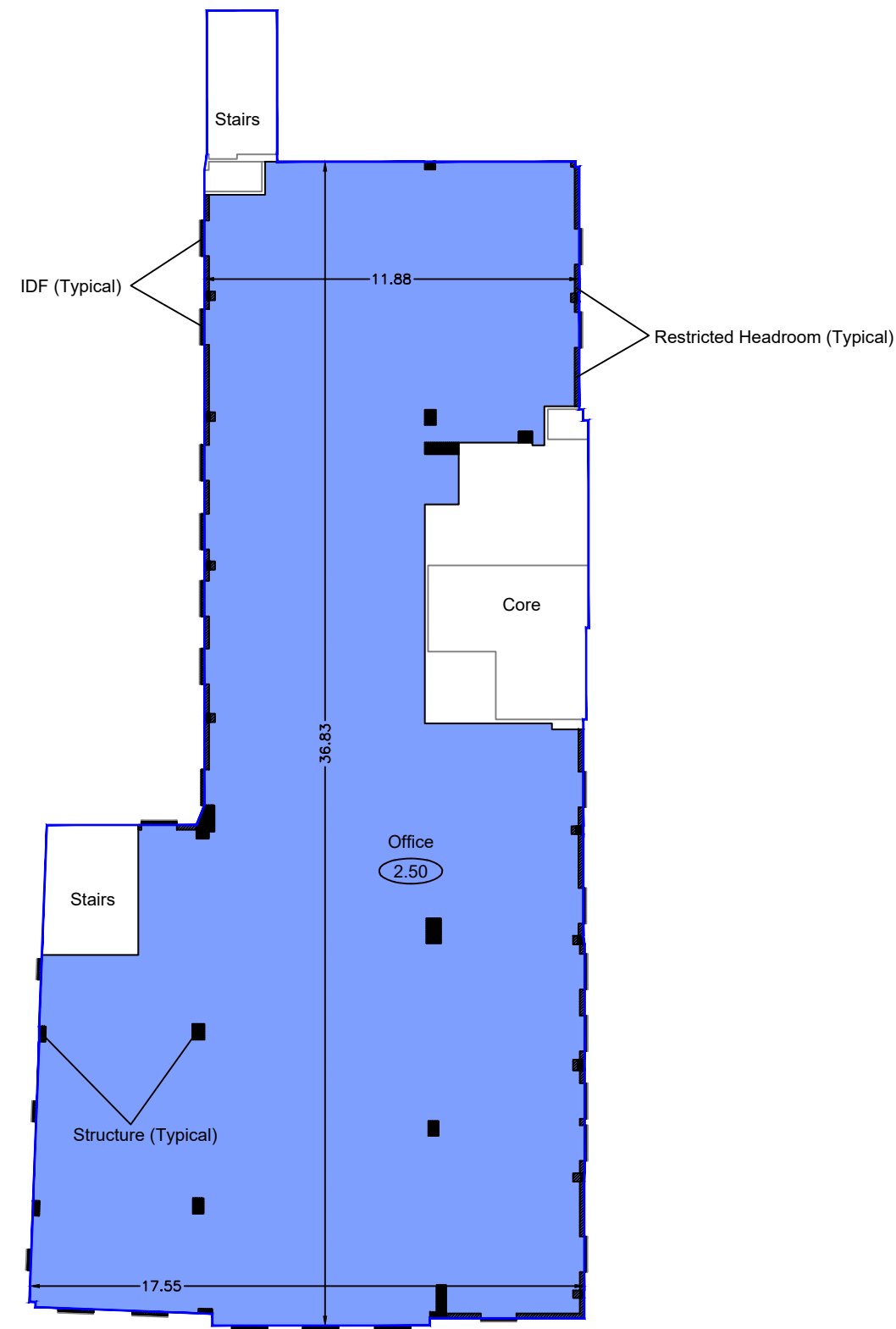

HAYGARTH PLACE

HIGH STREET

Notes:

(X.XX) - Floor to Ceiling Height (Metres)

A dashed line denotes assumed - inaccessible due to fit out.

This drawing indicates the extent of the areas quoted, produced to an accuracy commensurate with standard presentation scales. It is held in a scaled digital CAD format.

Dwg No. LF7172-AREA-02

Issue A November 2025

Scaled for presentation - 1:200 @ A3

Lane &
Frankham

